



Exchanging (Swapping) the Remote Telemetry Unit

SmartTank Swap

In this section, you will learn how exchange the entire monitor on a tank, to retain the tank's historical data of the previous unit using SmartTank.

Step 1: Before making any changes in SmartTank, the first step should be to initiate a call out from the unit that will be removed from the tank, either by a button push or mag swipe. This will ensure the existing unit's inventory reading can be compared to the new monitor being installed for validation purposes.

Step 2: Physically remove the old monitor and install the new SkyBitz monitor.

Step 3: Make the appropriate updates in SmartTank as noted below:

Search for the Serial # of the unit you are physically removing from the tank in SmartTank & click on the Tank Name then complete the following steps:

- Click the Service Tab of the device being replaced.
- In the Swap monitor Device pane, enter the MIN or serial number of the replacement device that is being physically installed in the MIN#/MONITOR ID text box.
- Click the Search button.

Return To Tank List | Previous Tank | Next Tank

Details | Map | Permissions | History | Usage | Setup | Alarms | Service | **Setup New Tank** | Setup Alarms

Tank Details

Tank Name:	1	Cellular ID:	10354	Location:	Atlanta R&D
Organization:	ACME Co	Serial Number:	210510984	Address:	2727 Paces Ferry Rd., Atlanta, GA - 30339-4053
Number:	1	Product/SGU:	Unleaded - 1.00000		

Tank Service

Swap RTU Device

WARNING! THIS SECTION IS FOR SWAPPING TANKS ONLY!

MIN # / RTU ID:

All Organizations Search Clear

Organization Name:

Replacement RTU:

Tank Name:

Location:

Address:

Alternate RTU Device Destination

Select desired end location for failed device:

Min #:

RTU ID:

Tank Number:

Sensor Type:

Sensor Length:

RTU Model Type:

Swap

- In the Replacement Monitor dropdown list, select the unit you wish to replace the current unit with. The screen displays the location of the selected unit. Any differences between the unit types will be highlighted in red to ensure the correct unit type is being swapped in or out. Important: If there are multiple choices to select from, be sure to choose the correct tank number.
- Click the Swap button.

The new monitor will now be associated with the current tank.

Note: The tank name of the unit that was replaced will be renamed with the prefix “was[space].”

Step 4: Initiate a call out of the new unit via mag swipe

- Then validate that the tanks’ manual level reading (and previous monitors reading) matches that of the levels indicated in SmartTank.
- Use the Tank Details page to see the most recent inventory reading.

Details | Map | Permissions | History | Usage | Setup | Alarms | Service | **Setup New Tank** | Setup Alarms

Tank Details

Tank Name:	1	Cellular ID:	10348	Location:	Atlanta R&D
Organization:	ACME Co	Serial Number:	210510819	Address:	2727 Paces Ferry Rd., Atlanta, GA - 30339-4053
Number:	1	Product/SGU:	Unleaded - 1.00000		

Tank Status

Inventory Time:	3/30/2023 1:59:02 PM
Primary Location Contact:	Not Assigned
Alarm Status:	OK
Comm Status:	OK
Maintenance Status:	OK
Sensor Status:	OK
Level:	92.3 in
Inventory:	12606.0 gal
Tank Type:	Standard Horizontal Cylindrical Tank
Tank Height:	96.0 in
Tank Number:	1
Region:	
Route:	
User Defined:	
User Defined (B):	
Key Note:	

Tank Level

12606 gal **84%**

There are no photos associated with this tank.

Mobile App Swap

In this section, you will learn how exchange/swap the entire monitor on a tank, to retain the tank's historical data of the previous unit using the SkyBitz Mobile App.

Step 1: Before making any changes via the Mobile App, the first step should be to initiate a call out from the unit that will be removed from the tank, either by a button push or mag swipe. This will ensure the existing unit's inventory reading can be compared to the new monitor being installed for validation purposes.

Step 2: Physically remove the old monitor and install the new SkyBitz monitor.

Step 3: Make the appropriate updates via the Mobile App as noted below:

Search for the Serial # of the unit you are physically removing from the tank in the SkyBitz Mobile App & click on the Tank Name then complete the following steps:

- From the Tank Details page, select the Service Tab of the telemetry unit you are installing, and select **Swap**

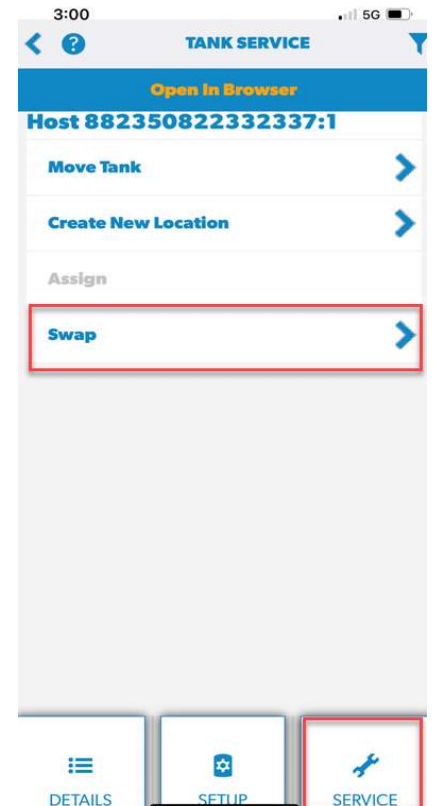

- In the Swap Device pane, click on “**Click to select**” button enter the MIN# or RTU ID number of the Replacement Device that is being physically installed in the MIN#/ MONITOR ID text box

- Then click the Search icon to select the monitor.

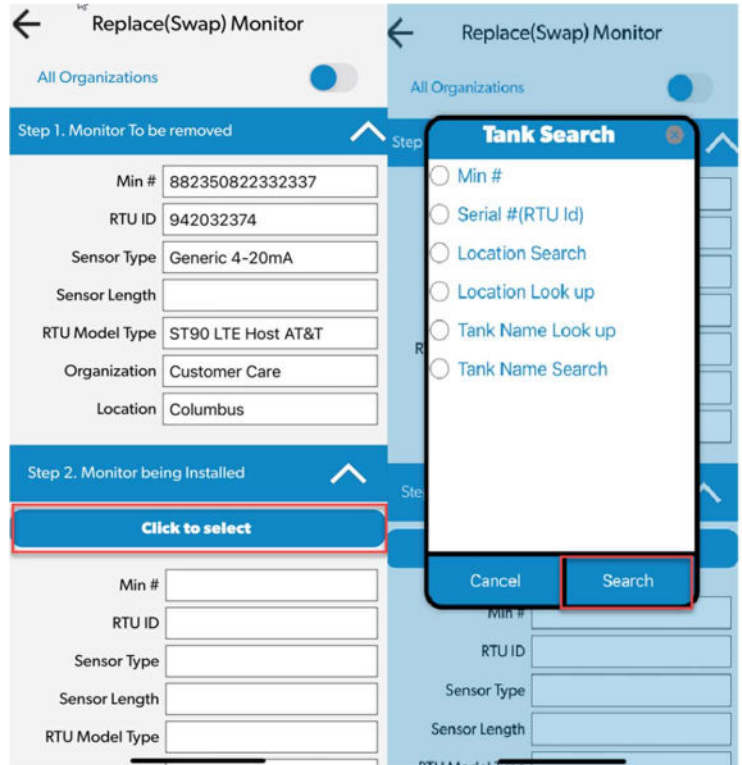

- Validate the correct monitor is displaying to swap, then click the **Green “Swap”** Button.

The new monitor will now be associated with the current tank.

Note: The tank name of the unit that was replaced will be renamed with the prefix “was[space].”

Step 4: Initiate a call out of the new unit via mag swipe

- Then validate that the tanks’ manual level reading (and previous monitors reading) matches that of the levels indicated in SmartTank.

- Use the Tank Details page to see the most recent inventory reading.

